

# Tollok Locking Assemblies

## TLK 200 & 250L - Non Self Centering - Medium Torque

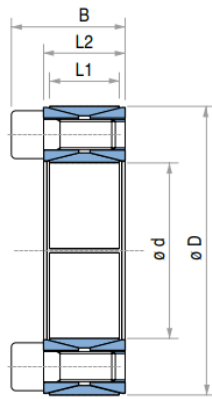

TLK 200															
Dimensions					Shaft / Hub Tolerance h11/H11				Shaft / Hub tolerances h7 / H7		Tightening Screws			Weight	
d	D	L1	L2	B	Torque Mt Nm	Axial Force Fax KN	Surface Pressures on		Torque Mt N/mm <sup>2</sup>	Pressure on Hub Pn N/mm <sup>2</sup>	DIN912 12.9		Tightening Torque Ms Nm		Kg
							Shaft Pw N/mm <sup>2</sup>	Hub Pn N/mm <sup>2</sup>			No.	Type			
20	47	17	20	26	330	33	260	110	370	125	8	M6	17	0.2	
22	47	17	20	26	360	33	235	110	410	125	8	M6	17	0.2	
24	50	17	20	26	390	33	215	105	440	115	8	M6	17	0.3	
25	50	17	20	26	410	33	205	105	460	115	8	M6	17	0.3	
30	55	17	20	26	610	41	215	115	690	130	10	M6	17	0.3	
32	60	17	20	26	780	49	240	130	890	145	12	M6	17	0.3	
35	60	17	20	26	850	49	220	125	970	145	12	M6	17	0.3	
38	65	17	20	26	1070	57	235	135	1230	155	14	M6	17	0.4	
40	65	17	20	26	1120	56	220	135	1300	155	14	M6	17	0.3	
42	75	20	42	32	1860	89	280	155	2170	185	12	M8	41	0.6	
45	75	20	42	32	1990	89	260	155	2320	185	12	M8	41	0.6	
48	80	20	24	32	2120	88	245	145	2480	170	12	M8	41	0.6	
50	80	20	24	32	2200	88	235	145	2580	170	12	M8	41	0.6	
55	85	20	24	32	2810	102	160	160	3310	190	14	M8	41	0.6	
60	90	20	24	32	3050	102	225	150	3610	180	14	M8	41	0.7	
65	95	20	24	32	3770	116	235	160	4470	190	16	M8	41	0.7	
70	110	24	28	38	5600	160	255	160	6700	190	14	M10	83	1.3	
75	115	24	28	38	5970	159	235	155	7170	185	14	M10	83	1.3	
80	120	24	28	38	6330	158	220	145	7650	175	14	M10	83	1.4	
85	125	24	28	38	7660	180	235	160	9290	195	16	M10	83	1.4	
90	130	24	28	38	8080	180	220	155	9840	185	16	M10	83	1.5	
95	135	24	28	38	9560	201	235	165	11600	200	18	M10	83	1.6	
100	145	26	33	45	11300	227	230	160	13900	195	14	M12	145	2.2	
110	155	26	33	45	12400	226	210	150	15300	185	14	M12	145	2.5	
120	165	26	33	45	15400	258	220	160	19100	195	16	M12	145	2.6	
130	180	34	38	50	20800	320	190	140	25800	175	20	M12	145	3.8	
140	190	34	38	50	24500	351	195	145	30600	180	22	M12	145	3.9	
150	200	34	38	50	28500	381	200	150	35800	185	24	M12	145	4	

\* Also Stocking: TLK250L-25X35

\* All other TLK200 & TLK250 Locking Assemblies available on request.

Table continued on next page.

# Tollok Locking Assemblies

TLK 200 & 250L - Non Self Centering - Medium Torque

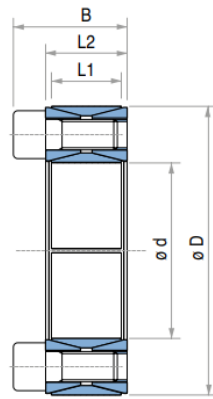

TLK 200															
Dimensions					Shaft / Hub Tolerance h11/H11				Shaft / Hub tolerances h7 / H7		Tightening Screws			Weight Kg	
d	D	L1	L2	B	Torque Mt Nm	Axial Force Fax KN	Surface Pressures on		Torque Mt N/mm <sup>2</sup>	Pressure on Hub Pn N/mm <sup>2</sup>	DIN912 12.9		Tightening Torque Ms Nm		
							Shaft Pw N/mm <sup>2</sup>	Hub Pn N/mm <sup>2</sup>			No.	Type			
160	210	34	38	50	32900	411	200	155	41400	190	26	M12	145	4.3	
170	225	38	44	58	40400	476	195	150	51000	185	22	M14	230	5.8	
180	235	38	44	58	46500	518	200	155	59000	195	24	M14	230	6	
190	250	46	52	66	57200	602	185	140	72600	175	28	M14	230	8.5	
200	260	46	52	66	64200	643	185	145	81900	180	30	M14	230	8.6	
220	285	50	65	72	84500	769	185	145	108500	185	26	M16	355	11	
240	305	50	56	72	106000	884	195	155	136600	200	30	M16	355	12	
280	355	60	66	84	157200	1123	175	140	204600	180	32	M18	485	19	
320	405	72	78	98	259400	1622	185	150	341400	195	36	M20	690	30	
400	495	84	90	112	397000	1985	155	125	387273	185	36	M22	790	46	

\* Also Stocking: TLK250L-25X35

\* All other TLK200 & TLK250 Locking Assemblies available on request.