

Tollok Locking Assemblies

TLK 400 & 401 - Self Centering - Very High Torque

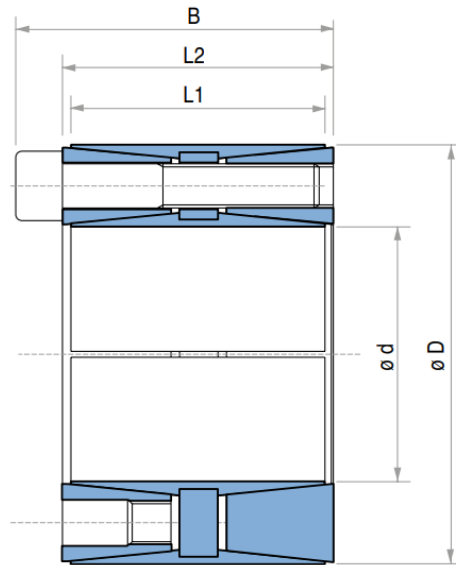

TLK 400												
Dimensions					Tightening Screws			Torque	Axial Force	Surface pressures		Weight
					DIN912 12.9		Tightening Torque			Shaft	Hub	
d	D	L1	L2	B	No.	Type	Ms Nm	Mt Nm	Fax KN	Pw N/mm ²	Ph N/mm ²	Kg
100	145	90	100	112	12	M12	145	26900	538	160	110	6.0
110	155	90	100	112	12	M12	145	29530	538	143	102	6.2
120	165	90	100	112	14	M12	145	37610	628	154	112	6.8
130	180	104	116	130	12	M14	230	48000	738	143	106	9.8
140	190	104	116	130	14	M14	230	60290	861	160	117	10.2
150	200	104	116	130	16	M14	230	73800	985	165	125	10.9
190	250	134	146	162	16	M16	355	129880	1368	141	110	21.5
200	260	134	146	162	16	M16	355	136840	1368	137	104	22.0
240	305	134	146	162	22	M16	355	225000	1880	155	120	27
260	325	134	146	162	22	M16	355	244000	1880	155	115	20.0
300	375	165	177	197	22	M20	690	440000	2930	155	125	50.0

* All other TLK400 Locking Assemblies available on request

TLK 401												
Dimensions					Tightening Screws			Torque	Axial Force	Surface pressures		Weight
					DIN912 12.9		Tightening Torque			Shaft	Hub	
d	D	L1	L2	B	No.	Type	Ms Nm	Mt Nm	Fax KN	Pw N/mm ²	Ph N/mm ²	Kg
75	115	50	58	68	8	M10	82.76	9160	245	155	115	2.40
90	130	50	58	68	10	M10	82.76	13701	307	181	125	2.72
110	155	60	70	80	10	M10	82.76	16900	307	127	88	4.49

* All other TLK401 Locking Assemblies available on request