

Finer Power Transmissions stocks a range of ASA high quality steel sprockets. They are complete with induction hardened teeth, thus improving the sprockets resistance to wear and increasing the sprockets working life.

All Finer sprockets are engineered in accordance with the stringent ISO 9000 standards.

## 25-1 Sprocket

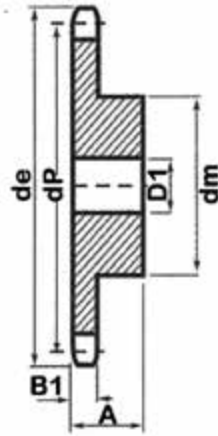
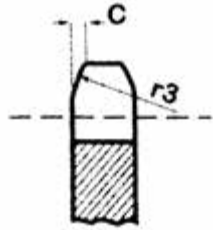

Pinions	mm
Tooth Radius r3	6
Radius Width C	0.6
Tooth Width B1	2.9

Chain	mm
Pitch	6.35
Inside	3.18
Roller $\phi$	3.3

Teeth	de	dp	Simplex		
			dm	D1	A
9	18.1	16.59	10	5	15
10	22.3	20.55	11	5	15
11	24.3	22.54	14	6	15
12	26.4	24.33	16	6	15
13	28.5	26.53	18	6	15
14	30.5	28.53	20	6	15
15	32.5	30.55	22	6	15
16	34.5	32.55	24	8	15
17	36.5	34.55	26	8	15
18	38.5	36.56	28	8	15
19	40.5	38.58	30	8	15
20	42.5	40.58	32	8	15
21	44.6	42.60	34	8	15
22	46.6	44.62	36	8	15
23	48.6	46.63	38	8	15
24	50.6	48.64	40	8	15
25	52.6	50.66	42	8	18
26	54.6	52.67	44	10	18
27	56.51	54.69	46	10	18
28	58.7	56.71	48	10	18
29	60.7	58.73	48	10	18
30	62.7	60.75	48	12	18
35	72.8	70.84	50	12	18
38	78.8	76.89	50	12	18
45	93.0	91.03	50	12	18
50	104	102	50	12	20
57	117.2	115.27	OA	OA	OA
76	155.6	153.66	OA	OA	OA