

Finer Power Transmissions stocks a range of British Standard high quality steel sprockets. They are complete with induction hardened teeth, thus improving the sprockets resistance to wear and increasing the sprockets working life.
All Finer sprockets are engineered in accordance with the stringent ISO 9000 standards.

05B-1 Sprocket

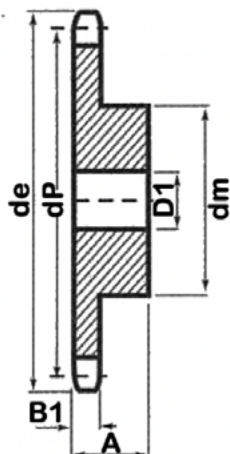
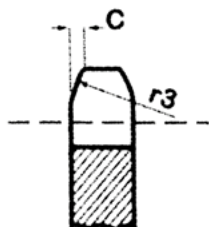

| Pinions | mm |
|-----------------|-----|
| Tooth Radius r3 | 8 |
| Radius Width C | 1 |
| Tooth Width B1 | 2.8 |

| Chain | mm |
|---------------|----|
| Pitch | 8 |
| Inside | 3 |
| Roller ϕ | 5 |

| Teeth | de | dp | Simplex | | |
|-------|-------|-------|---------|----|----|
| | | | dm | D1 | A |
| 9 | 25.09 | 23.99 | 15 | 6 | 12 |
| 10 | 28.4 | 25.89 | 17 | 6 | 12 |
| 11 | 31 | 28.39 | 18 | 7 | 13 |
| 12 | 33.7 | 30.91 | 20 | 7 | 13 |
| 13 | 36.7 | 33.42 | 23 | 7 | 13 |
| 14 | 39.2 | 35.95 | 25 | 7 | 13 |
| 15 | 41.7 | 48.48 | 28 | 7 | 13 |
| 16 | 44.2 | 41.01 | 30 | 8 | 14 |
| 17 | 46.7 | 43.53 | 30 | 8 | 14 |
| 18 | 49.2 | 46.07 | 30 | 8 | 14 |
| 19 | 51.7 | 48.61 | 30 | 8 | 14 |
| 20 | 54.2 | 51.14 | 30 | 8 | 14 |
| 21 | 57.2 | 53.67 | 35 | 8 | 14 |
| 22 | 59.2 | 56.21 | 35 | 8 | 14 |
| 23 | 62.2 | 58.75 | 35 | 8 | 14 |
| 24 | 64.7 | 61.29 | 35 | 8 | 14 |
| 25 | 67.2 | 63.83 | 35 | 8 | 14 |
| 26 | 69.7 | 66.37 | 40 | 10 | 16 |
| 27 | 72.3 | 68.91 | 40 | 10 | 16 |
| 28 | 74.7 | 71.45 | 40 | 10 | 16 |
| 29 | 77.3 | 73.99 | 40 | 10 | 16 |
| 30 | 80.2 | 76.53 | 40 | 10 | 16 |
| 32 | 85.2 | 81.61 | 40 | 12 | 16 |
| 34 | 90.2 | 86.7 | 40 | 12 | 16 |
| 36 | 95.2 | 91.79 | 40 | 12 | 16 |
| 38 | 100.2 | 96.88 | 40 | 12 | 16 |
| 40 | 105.2 | 102 | 40 | 12 | 16 |
| 57 | 149.3 | 145.2 | 80 | 14 | 20 |

