

Welded Hubs For use with Weld Fit Sprockets

	VT Series Hub		WT Series Hub		XT Series Hub	
	For VT sprockets		For WT sprockets		For XT sprockets	
A	34mm	(1-5/16)	45mm	(1-3/4)	62mm	(2-7/16)
B	30mm	(1-3/16)	41mm	(1-5/8)	57mm	(2-1/4)
C	12mm	(1/2)	12mm	(1/2)	12mm	(1/2)
D	18mm	(11/16)	25mm	(15/16)	25mm	(15/16)

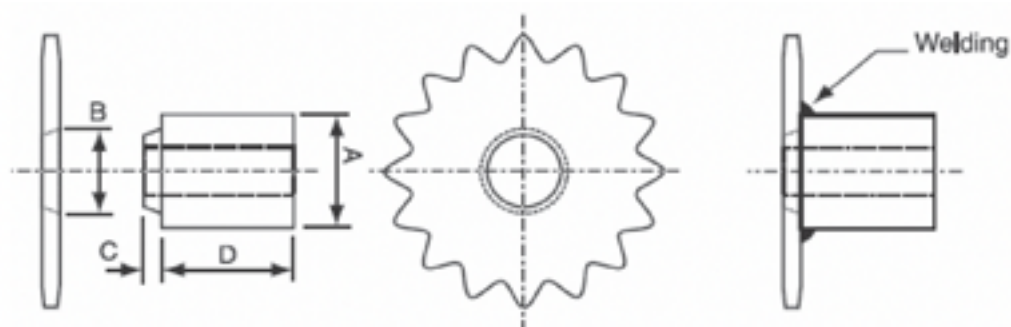

BORE					
Inch	mm	Inch	mm	Inch	mm
1/2	12	1/2	-	1/2	-
-	14	-	14	-	14
5/8	15	5/8	15	5/8	15
-	-	-	16	-	16
3/4	-	3/4	18	3/4	18
-	19	-	19	-	19
7/8	20	7/8	20	7/8	20
-	-	1	24	1	24
-	-	-	25	-	25
-	-	1-1/8	28	1-1/8	28
-	-	-	30	-	30
-	-	1-1/4	32	1-1/4	32
-	-	-	-	-	35
-	-	-	-	1-3/8	38
-	-	-	-	-	40
-	-	-	-	1-1/2	42
-	-	-	-	1-5/8	45
-	-	-	-	1-3/4	-



Notes

- 1) Welding with low hydrogen electrodes is recommended
- 2) Keyways conform to BS 46 (imperial) and BS 4235 (metric)